

AlloAid SubChon™

ENGINEERED ALLOGRAFT

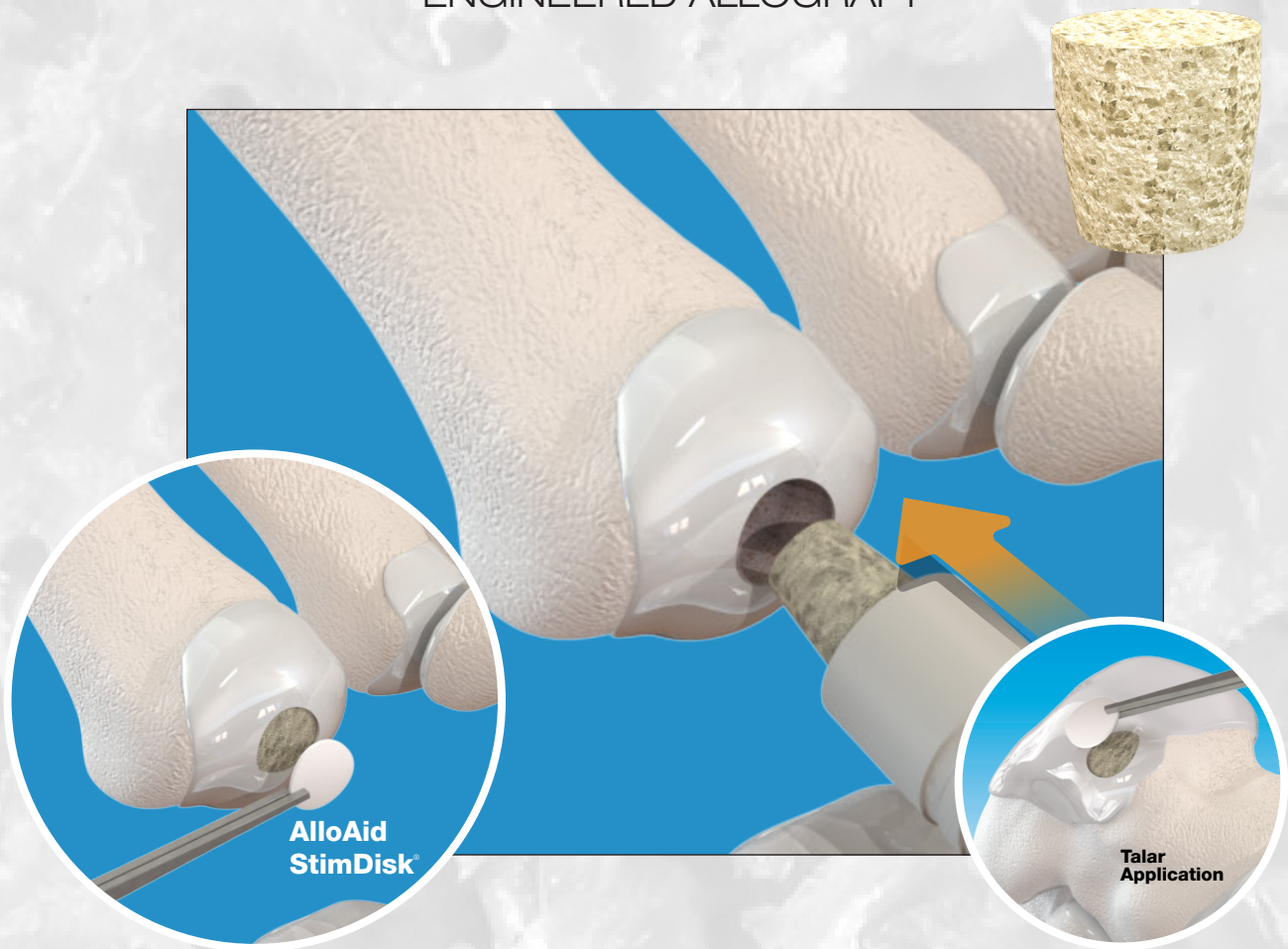

Tapered Design Resists Subsidence

Osteoconductive Porous Scaffold

Size Specific Instrumentation



AlloAid SubChon™

ENGINEERED ALLOGRAFT



AlloAid SubChon™ Implants are used to repair subchondral bone defects. The instruments remove the defective bony substructure and prepare a conical site for implantation. The AlloAid SubChon™ Implants are a proprietary, cancellous, allograft scaffold that resorbs over time and is replaced with new bone.

Surgical Technique

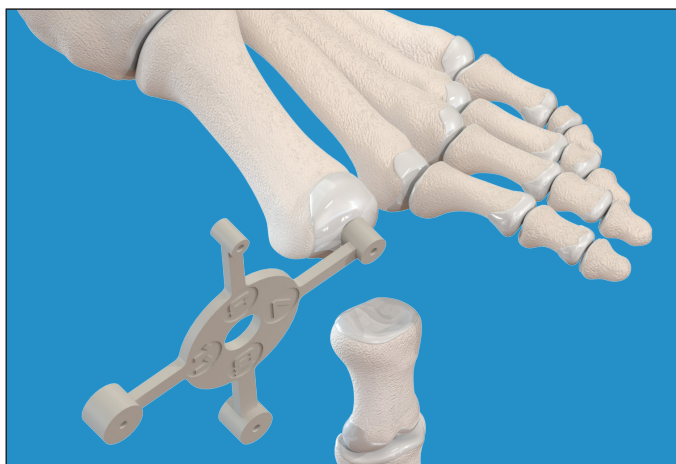

1. Defect Sizing

Using the Sizing Wheel, identify the appropriately sized allograft.

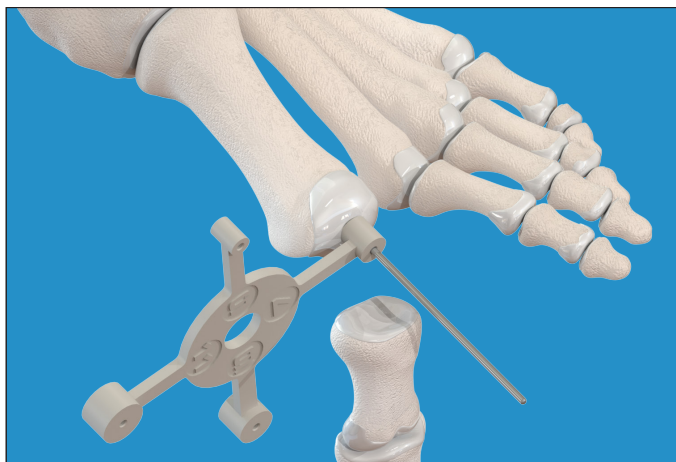
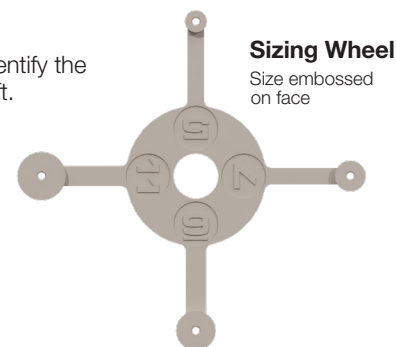

2. Guide Wire Placement

Drive the guide wire through the pin hole of the Sizing Wheel into and up the metatarsal shaft.

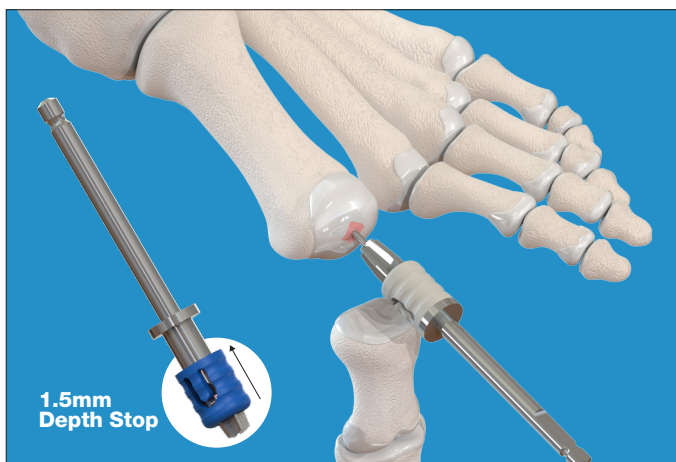

3. Site Preparation

Remove the Sizing Wheel and Place the reamer/depth stop assembly over the guide pin and ream until the depth stop contacts the head surface.

Note: To achieve a greater ream depth when a thicker cover is required, remove the Standard Depth Stop (beige) from the reamer assembly and assemble the 1.5mm Depth Stop (blue) to the Reamer. Ream until the depth stop contacts the head surface.

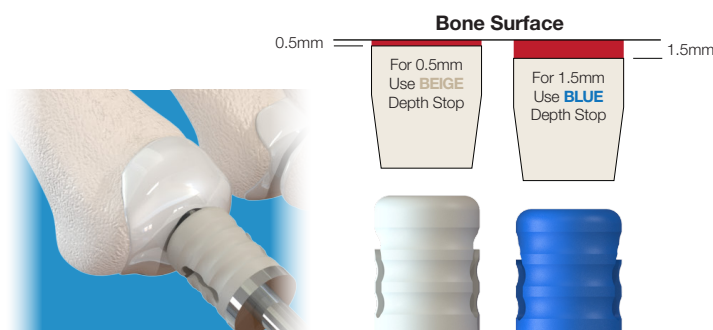

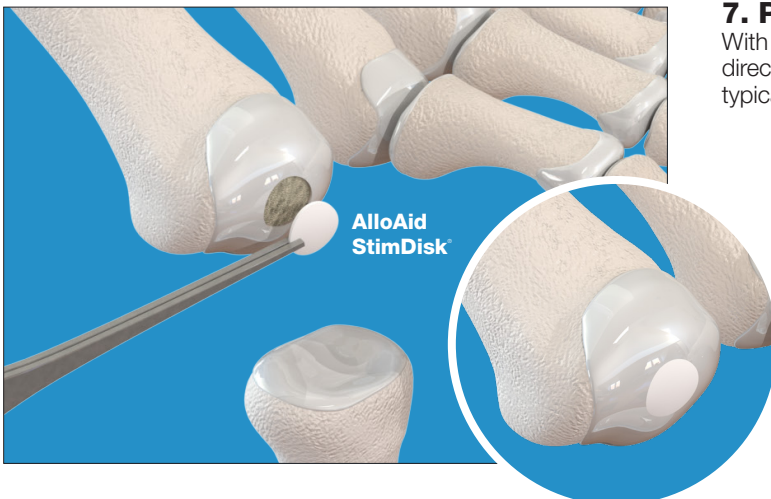
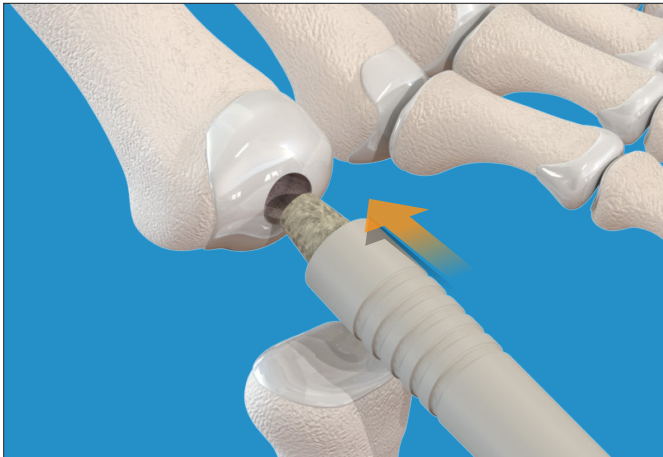
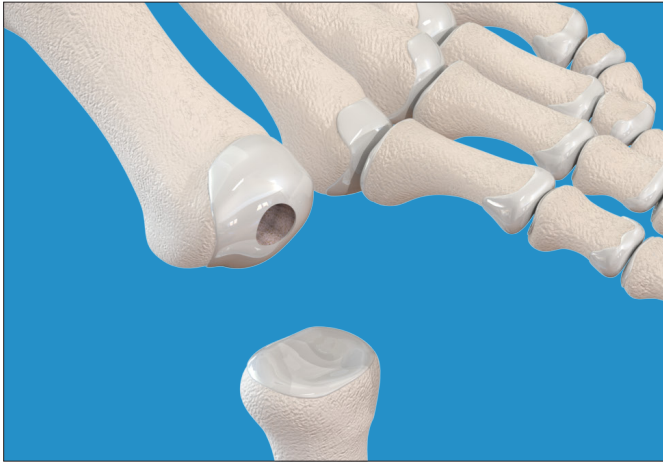

4. Finish Site Prep

Remove Guide Wire and Reamer, then irrigate the reamed area.

5. Implant Preparation

Manually insert the non-tapered end of the implant into the Inserter Assembly.

Note: Avoid applying too much pressure on the implant during assembly to prevent damage to the implant. Only a minimal stick fit is required to hold the implant.

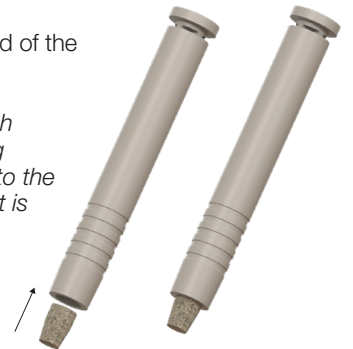

6. Allograft Placement

With the Inserter Assembly over the implant and in contact with the head surface, push the Inserter Tamp until it contacts the sleeve end. To fully insert, a mallet may be utilized to finish impacting. The insertion Tamp is intended to seat the implant approximately 0.5mm recessed in the bone.

Note: If shaping or further impaction is necessary, remove the tamp from the sleeve to finish. Further impaction with tamp is required to fully seat the implant when reaming with the 1.5mm Depth Stop.



Tamp
Sleeve Removed

7. Place AlloAid StimDisk®

With a dry forceps, place the appropriately sized AlloAid StimDisk® directly from the packaging over the allograft. Close the soft tissue in typical fashion.

Note: A thicker cover is recommended for use with the 1.5mm Depth Stop.

Talar Application

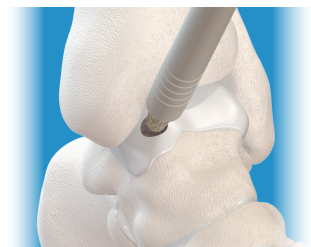

AlloAid SubChon™

ENGINEERED ALLOGRAFT



ORDER INFO

CAT NO.	DESCRIPTION	DIA (A) X LENGTH (B)
ASB 005	AlloAid SubChon Implant - 5mm	5 x 10mm
ASB 007	AlloAid SubChon Implant - 7mm	7 x 10mm
ASB 009	AlloAid SubChon Implant - 9mm	9 x 10mm
ASB 011	AlloAid SubChon Implant - 11mm	11 x 11mm

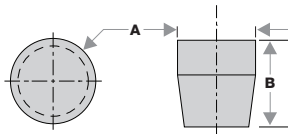

**Tapered Design
Resists Subsidence**

AlloAid SubChon Instrument Kits

CAT NO.	DESCRIPTION
C01 S1001	AlloAid SubChon Sizing Kit, Single-Use, Sterile
C01 S1505	AlloAid SubChon Instrument Kit, Size 5mm, Single-Use, Sterile
C01 S1507	AlloAid SubChon Instrument Kit, Size 7mm, Single-Use, Sterile
C01 S1509	AlloAid SubChon Instrument Kit, Size 9mm, Single-Use, Sterile
C01 S1511	AlloAid SubChon Instrument Kit, Size 11mm, Single-Use, Sterile

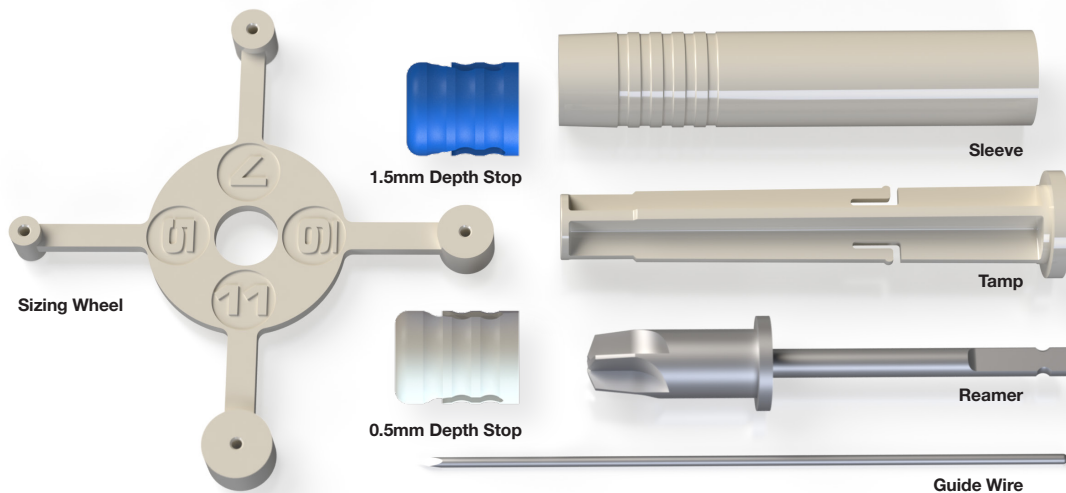

AlloAid StimDisk®

This membrane consists of fibrillar and membranous collagens, elastin, and a mix of growth factors and cytokines.



ORDER INFO

CAT NO.	DESCRIPTION	DIAMETER	CORRESPONDING SUBCHON SIZE
ASD 006	AlloAid StimDisk	6mm	5mm
ASD 008	AlloAid StimDisk	8mm	7mm
ASD 010	AlloAid StimDisk	10mm	9mm
ASD 012	AlloAid StimDisk	12mm	11mm

All content contained herein is furnished for informational purposes only. In2Bones does not recommend a particular surgical product or procedure suitable for all patients. Each surgeon must evaluate the appropriateness of a device and corresponding techniques based on medical training, clinical judgment and surgical experience. The proper surgical technique and/or procedure are the responsibility of the medical professional. Indications, contraindications, warnings, and precautions are listed in the implant package insert and should be reviewed carefully by the physician and operating room personnel prior to any proposed procedure. Availability of these products might vary from a given country or region to another as a result of specific local regulatory approval or clearance requirements for sale in such country or region.

CAUTION: Federal law (USA) restricts this device to sale and use by, or on the order of a physician.



Corporate Headquarters

In2Bones Global, Inc. • Memphis, TN • USA
844. 602. 6637 • Info@i2b-USA.com

International Office

In2Bones SAS • Lyon • France
+33 (0)4 72 29 26 26

FOLLOW US....



In2Bones.com

™ and © denote trademarks and registered trademarks of In2Bones or its affiliates. In2Bones USA Memphis TN, 38119 USA / In2Bones SAS, 69130 Ecully, France © 2022 In2Bones USA, Memphis, TN • Patent Pending • All rights reserved • SP-21005-01 Rev. D, 1222