

BUFFALO FILTER®

ULPA/Charcoal Filter Direct Replacement For Valleylab® E3625 BFE3625 - DIRECTIONS FOR USE

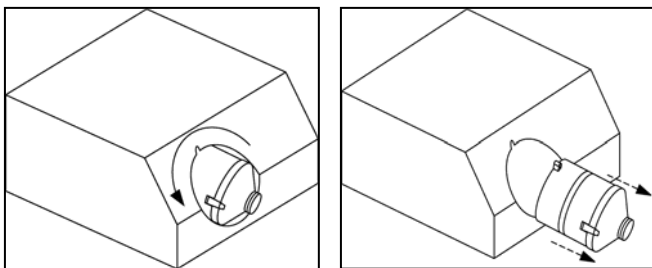
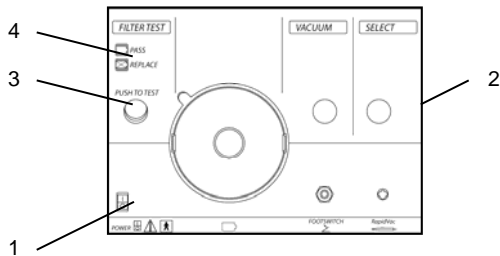
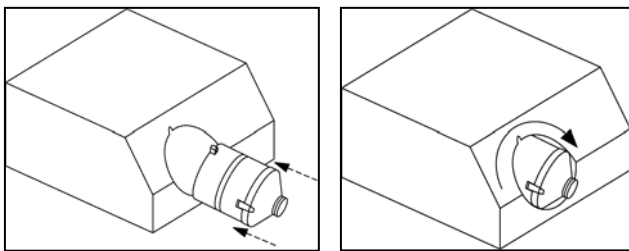
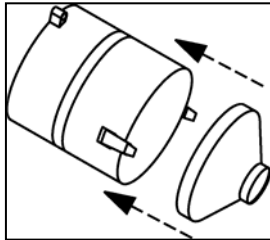

Before Use

1. Prior to installation into smoke evacuation system, place prefilter (Buffalo Filter Part Number: BFE3630) onto the ULPA Filter. The two locking tabs will hold prefilter in place.
2. Install the filter assembly into the smoke evacuator as shown by aligning the key locking mechanism with the slot on the face plate of the smoke evacuator. Slide the filter into the smoke evacuator and rotate the filter clockwise.
3. Test the filter and new prefilter prior to use (do not attach any tubing or adapters) by pressing the power switch (1) to on and setting the mode indicator (2) to any position. Press filter test button (3). If the Filter Status illuminates green (4) – filter is functioning properly. If the Filter Status illuminates red (4) – replace filter.

Filter Replacement

4. To replace ULPA filter, rotate filter counter clockwise as shown, slide filter assembly out of smoke evacuator. Dispose of filter assembly (ULPA and prefilter) according to standard practices in your facility. Prefilter is single use, replace after each use. Disengage the two locking tabs to remove the prefilter.
5. Refer to operator/user guide for smoke evacuation system for additional information regarding installation, testing, removal or disposal instructions for filter assembly.

Warnings & Caution:

Filter test **MUST** be completed prior to use of smoke evacuation system. This test will insure smoke evacuator will perform properly. With the use of any accessories, i.e., filters, tubing, reducers, handle as you would any other biohazardous material. Dispose of these items according to the procedures for your institution.

Buffalo Filter®
5900 Genesee Street
Lancaster, New York 14086
(716)835-7000

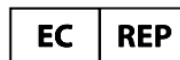

Emergo Europe
Molenstraat 15
NL-2513 BH The Hague
The Netherlands

For ordering information:
(716)835-7000 (800)343-2324
900236REVB DFU BFE3625.doc

